

| ITEM | PART NO | DESCRIPTION |
|------|------------|------------------------------|
| 1 | | 5/16-18x2 STOVER BOLT |
| 2 | 700-022 | TENSION SHAFT IDLER YOKE |
| 3 | 455-004 | TENSION RELEASE LEVER |
| 4 | 697-024 | TENSION SPRING |
| 5 | | FLAT HEAD ALLEN SCREW |
| 6 | 563-014 | PLATEN |
| 7 | 291-018 | FRAME SANDER |
| 8 | 123-003 | COLLAR |
| 9 | 960-002 | YOKE |
| 10 | 5100-50 | RETAINING RING |
| 11 | 560-006 | IDLER PULLEY W/BEARINGS |
| | 560-006IPA | IDLER PULLEY ASSY (OPTIONAL) |
| 12 | 701-008 | IDLER SPINDLE |
| 13 | 710-415 | PUSHBUTTON ENCLOSURE |
| | 710-031 | GREEN BUTTON |
| | 710-032 | RED STOP BUTTON |
| 14 | 701-039 | DRIVE SPINDLE-S460W |
| 15 | 560-052 | MOTOR SHEAVE 2/3V26.5JA |
| | 049-030 | MOTOR BUSHING JAX678 |
| 16 | | SPLASH GUARD |
| 17 | | 5/16-18x1-1/2 H.H.C.S. |
| 18 | | 5/16 LOCK WASHER |
| 19 | 441-014 | KNOB |
| 20 | 697-017 | SPRING |
| 21 | | WASHER |
| 22 | 291-028 | FRAME & DOOR ASSY |
| 23 | 698-011 | STUD, 3/8x6-1/2 |
| 24 | 441-017 | TRACKING KNOB |
| 25 | 044-007 | K10 BEARING |
| 26 | 386-024 | BEARING HOUSING-S460W |
| 27 | 560-044 | DRIVE WHEEL-S460W |
| 28 | 044-001 | K12 BEARING |
| 29 | | 12W STAND |
| 30 | 486-006 | 35P35-5560 3HP 1PH S460W |
| 31 | 486-007 | 35P33-5561 3HP 3PH S460W |
| | | 1-1/2" PVC PIPE |
| 32 | 710-425 | 12X12 ENCLOSURE BOX |
| | 710-426 | 12X12 PANEL |
| 33 | 577-001 | 1 PHASE PUMP MOTOR |
| | 577-002 | 3 PHASE PUMP MOTOR |
| 34 | 716-011 | COOLANT TANK |
| 35 | 560-051 | SPINDLE SHEAVE 2/3V36.5SH |
| | 049-019 | SPINDLE BUSHING SHX678 |
| 36 | 829-034 | WORK TABLE |
| 37 | 051-006 | 3V37.5 V-BELT (2REQ) |
| 38 | | 1/2-13x1-1/2 S.H.C.S. |
| 39 | 342-077 | GUARD, UPPER |
| 40 | 048-019 | IDLER ADJUSTING BAR |

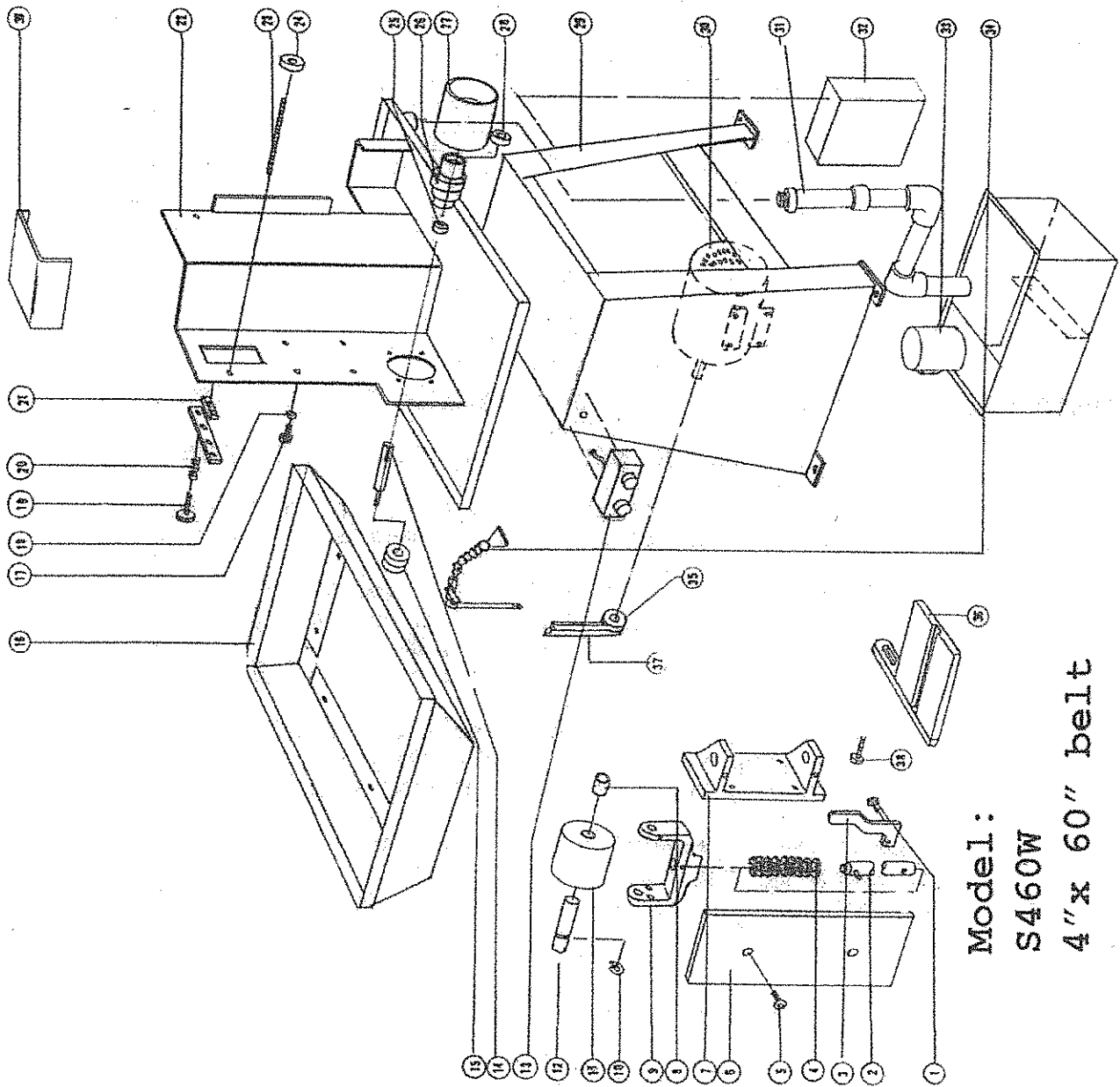

Model:
S460W
4" x 60" belt



6856 East K Avenue
Kalamazoo, MI 49048
269-382-2050 PH
269-382-0790 FAX
www.kalamazooindustries.com