

KALAMAZOO INDUSTRIES, INC.
6856 EAST K AVENUE
KALAMAZOO, MI 49048-6042
269-382-2050 PH 269-382-0790 FAX
Web site:
www.kalamazooindustries.com

INSTRUCTION MANUAL
FOR DS12V

DATE PURCHASED _____

KALAMAZOO INDUSTRIES, INC.

6856 EAST K AVENUE
KALAMAZOO, MI 49048-6042

269-382-2050 PHONE
269-382-0790 FAX

WEBSITE: www.kalamazooindustries.com

WARRANTY

- All products are guaranteed for a period of one year to the original purchaser, against defects in material workmanship under normal use.
- Electric motors are warranted by the motor manufacturer and will be repaired by the nearest motor repair station. If non-repairable, they will be replaced by Kalamazoo Industries. Please call for instructions.

RETURN POLICY

- Authorization must be obtained before returning merchandise. Please call our customer service department for a return authorization number at 269-382-2050.
- Please include with your return a copy of your invoice or packing slip.
- Materials must be sent back prepaid. (Unless otherwise indicated).
- All returns will be subject to a 10% restocking charge.
- No returns will be accepted after one year of invoice date.

DO YOU KNOW THAT

If these goods are damaged in transit, the DELIVERING TRANSPORTATION COMPANY is required by law to make notation of damages on the freight bill.

If in your opinion, there may be concealed damage, they are required to make an inspection after goods are unpacked. Transportation rates are made in proportion to damage.

Therefore, the carrier and NOT the shipper should be charged with any loss or damage. Any claim should be filed with the delivering Transportation Company.

**PLEASE DO NOT RETURN GOODS TO US
WITHOUT OUR RGA NUMBER AND SHIPPING INSTRUCTIONS.**

INSTRUCTION SHEET FOR DISC SANDERS

1. THIS MACHINE REQUIRES NO LUBRICATION AS THE BEARINGS ARE SEALED FOR LIFE
2. ALWAYS KEEP THE ALUMINUM SANDING DISC CLEAN SO THAT THE SANDING PAPER WILL ADHERE WELL.
3. THE SANDING TABLE IS ADJUSTABLE. KEEP THE TABLE WITHIN 1/8" OF THE SANDING DISC.
4. ALWAYS HOLD THE PART TO BE SANDED SECURELY. SAND PART ON THE DOWNWARD ROTATION SIDE OF THE SANDING DISC
5. WEAR PROPER RESPIRATORY PROTECTION TO PROTECT AGAINST DUSTS AND/OR VAPOR CREATED WHILE SANDING
6. KEEP SAFETY GUARDS IN PLACE AT ALL TIMES.
7. ALWAYS WEAR SAFETY GLASSES AND KEEP LONG HAIR TIED BACK.

KALAMAZOO INDUSTRIES, INC.
6856 EAST K AVENUE
KALAMAZOO, MI 49048-6042
269-382-2050 PHONE 269-382-0790 FAX

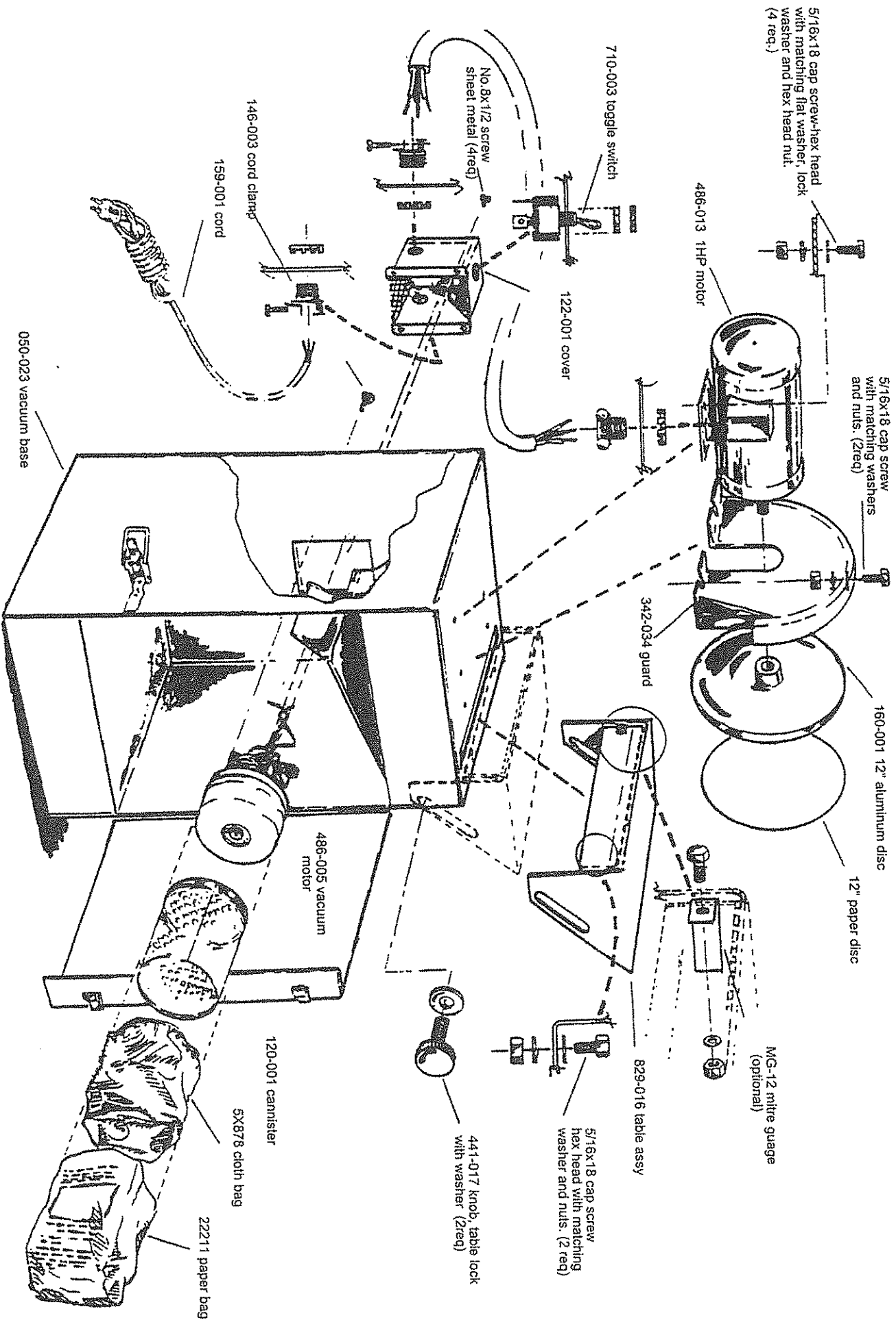

K Kalamazoo Industries, Inc.
 6856 East K Avenue
 Kalamazoo, MI 49048
 269-382-2050 PH
 269-382-0790 FAX

Model DS12V